



Complies with ErP Directive 2009/125/CE and EU Regulation 327/2011  
Classification FAN



### PERFORMANCE

MODELS	m <sup>3</sup> /h	l/s	W	A	dB(A)* at 3 m	
					Lw	Lp
AXM 100	160 / 250	44 / 69	35	0,1 / 0,18	55	39
AXM 125	180 / 300	50 / 83	36	0,1 / 0,18	54	44
AXM 150	340 / 480	94 / 133	70	0,27 / 0,36	66	50
AXM 160	340 / 480	94 / 133	70	0,27 / 0,36	65	50
AXM 200	720 / 820 / 910	200 / 228 / 253	75	0,24 / 0,27 / 0,34	58	43

\* Lp(A) measured at 3m in open field 230V-50Hz

- Duct fans, entirely made of polypropylene
- For direct installation between ducts
- Easy inspection and maintenance by simply opening the clamp and removing the fan
- Helicocentrifugal mixed flow impeller with downstream stator. Made in ABS
- Asynchronous motor, 2 and 3 speeds, depending on model
- IP 44 Protection, Motor Class B
- Robust motor with ball bearings, maintenance-free
- 220 - 240 V at 50 Hz
- Speed control using phase control or transformer (exception: Version with timer)
- Thermal overload protection as a standard feature
- Externally fitted terminal box with cable entry grommet

### BENEFITS

- High efficiency resulting in minimum energy costs.
- Quiet running thanks to optimized aerodynamics and guide vanes.
- Easy installation: pre-installed mounting brackets and external connection box.
- Simplified maintenance by loosening the clamps (no need to handle the duct).
- Versatile installation.

### VERSIONS



TIMER





### AXM 100

#### DIMENSIONS (mm)

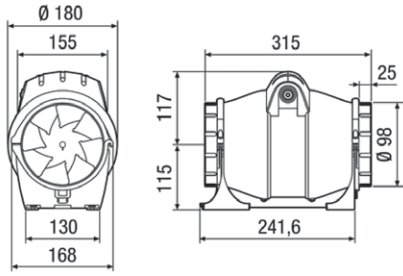

Kg. 2,1

#### CURVES

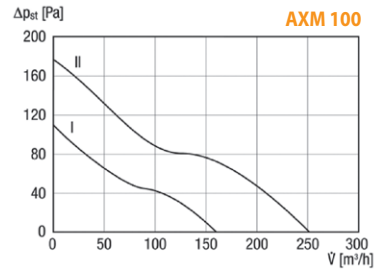

### AXM 125

#### DIMENSIONS (mm)

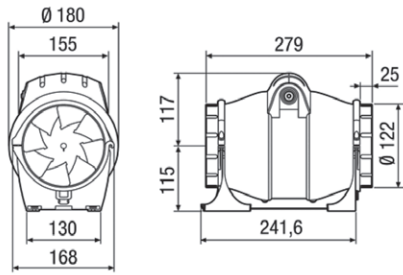

Kg. 2,1

#### CURVES

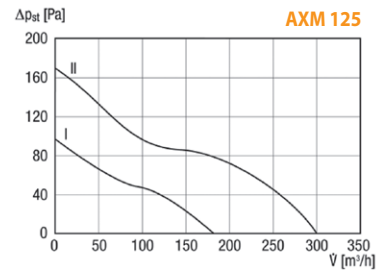

### AXM 150

#### DIMENSIONS (mm)

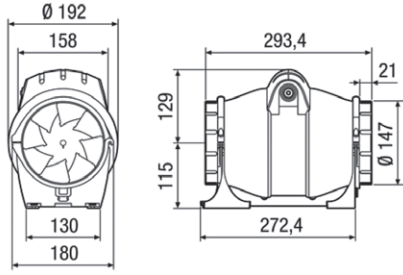

Kg. 3,2

#### CURVES

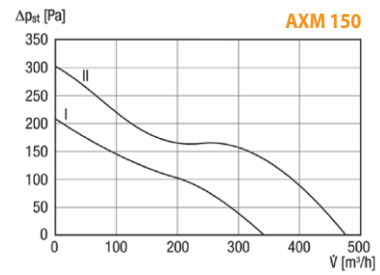

### AXM 160

#### DIMENSIONS (mm)

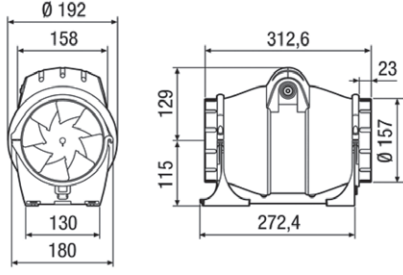

Kg. 3,2

#### CURVES

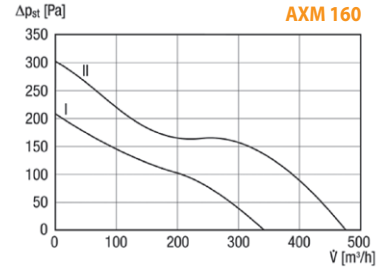

### AXM 200

#### DIMENSIONS (mm)

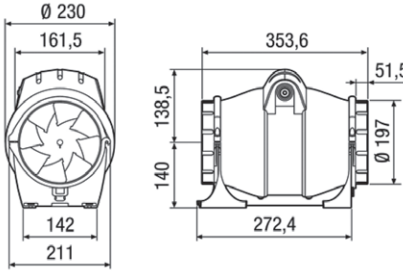

Kg. 4,5

#### CURVES

